

196x196

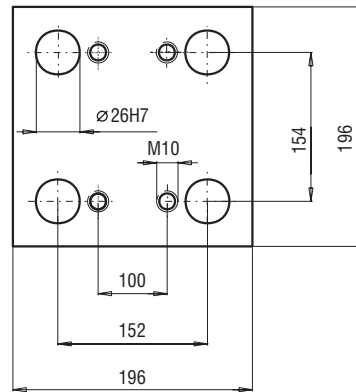

PK 01  
PK 11

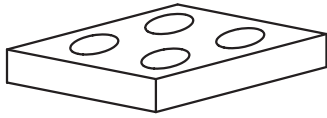
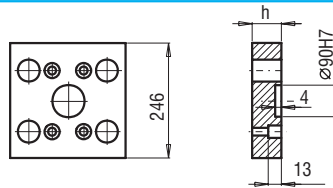
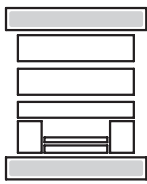

PK 01/246x196x

h	FCPK-1	FCPK-2
22	■	■
27	■	■

PK 11/246x196x

h	FCPK-1	FCPK-2
22	■	■
27	■	■

PK 02  
PK 12

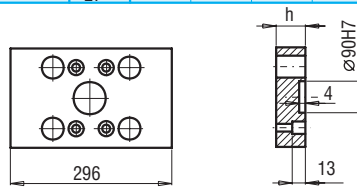
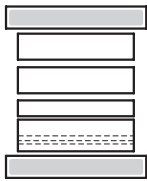

PK 02/196x296x

h	FCPK-1	FCPK-2
22	■	■
27	■	■

PK 12/196x296x

h	FCPK-1	FCPK-2
22	■	■
27	■	■

PK 21  
PK 22

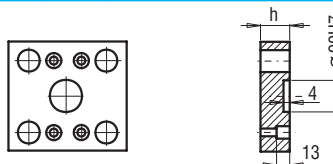
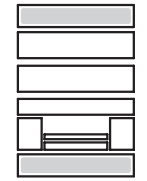

PK 21/196x196x

h	FCPK-1	FCPK-2
17	■	■
22	■	■

PK 22/196x196x

h	FCPK-1	FCPK-2
17	■	■
22	■	■

PK 03  
PK 31

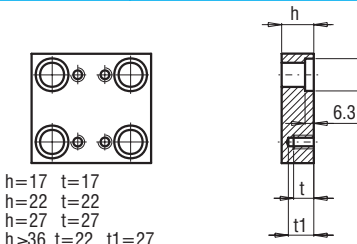
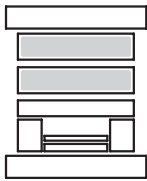

h=17 t=17  
h=22 t=22  
h=27 t=27  
h≥36 t=22 t1=27

PK 03/196x196x  
PK 31/196x196x

h	FCPK-1	FCPK-2	FCPK-3	*	*
17	■	■	■		
22	■	■	■		
27	■	■	■		
36	■	■	■		
46	■	■	■		
56	■	■	■		
66	■	■	■		
76	■	■	■		
86	■	■	■		
96	■	■	■		

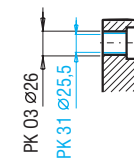

\*Inne gatunki materiałów - patrz str. I.3  
\*For other steel types - see page no I.3

PK 04

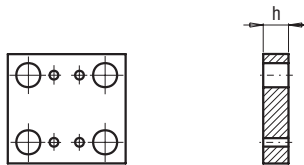
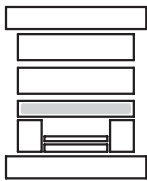

PK 04/196x196x

h	FCPK-1	FCPK-2
27	■	■
36	■	■

PK 05

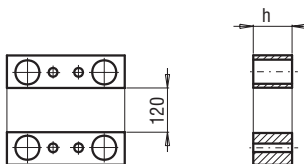
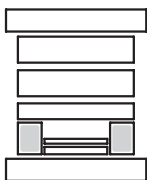

PK 05/38x196x

h	FCPK-1
46	■
56	■
76	■