

218x246

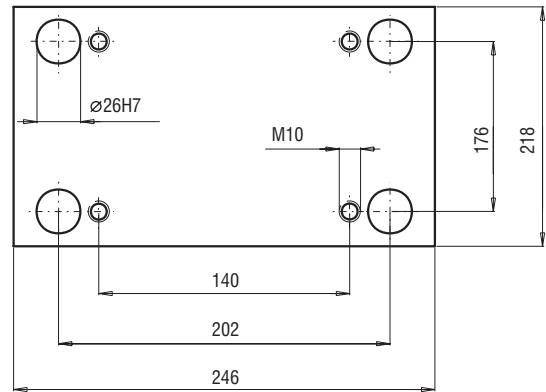

PK 01
PK 11

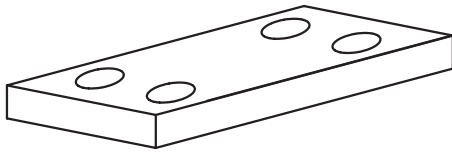
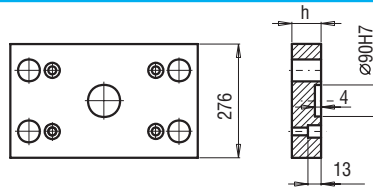
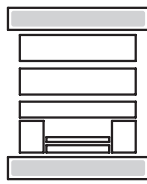

PK 01/276x246x	h	FCPK-1	FCPK-2		
	22	■	■		
	27	■	■		

PK 11/276x246x	h	FCPK-1	FCPK-2		
	22	■	■		
	27	■	■		

PK 02
PK 12

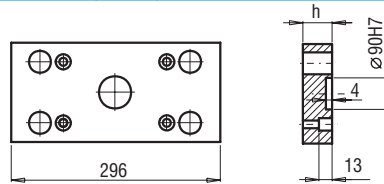
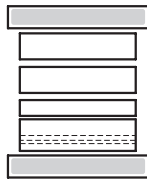

PK 02/218x296x	h	FCPK-1	FCPK-2		
	22	■	■		
	27	■	■		

PK 12/218x296x	h	FCPK-1	FCPK-2		
	22	■	■		
	27	■	■		

PK 21
PK 22

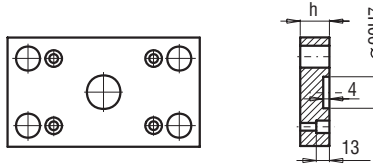
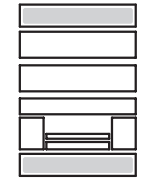

PK 21/218x246x	h	FCPK-1	FCPK-2		
	17	■	■		
	22	■	■		

PK 22/218x246x	h	FCPK-1	FCPK-2		
	17	■	■		
	22	■	■		

PK 03
PK 31

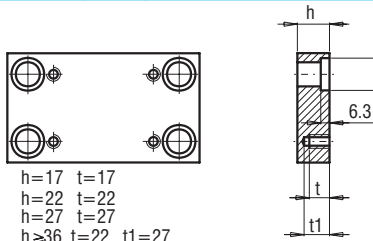
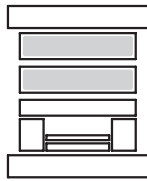

h=17 t=17
h=22 t=22
h=27 t=27
h≥36 t=22 t1=27

PK 03/218x246x PK 31/218x246x	h	FCPK-1	FCPK-2	FCPK-3	*	*
	17	■	■	■		
	22	■	■	■		
	27	■	■	■		
	36	■	■	■		
	46	■	■	■		
	56	■	■	■		
	66	■	■	■		
	76	■	■	■		
	86	■	■	■		
	96	■	■	■		

*Inne gatunki materiałów - patrz str. I.3
*For other steel types - see page no I.3

PK 04

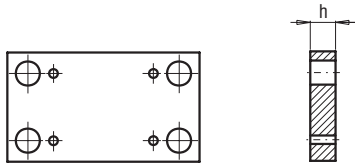

PK 04/218x246x	h	FCPK-1	FCPK-2		
	27	■	■		
	36	■	■		

PK 05

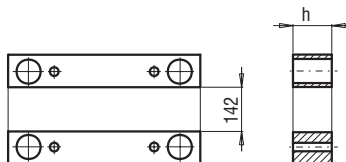
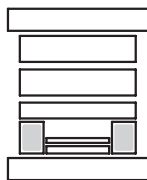

PK 05/38x246x	h	FCPK-1			
	46	■			
	56	■			
	76	■			