

**346x396**

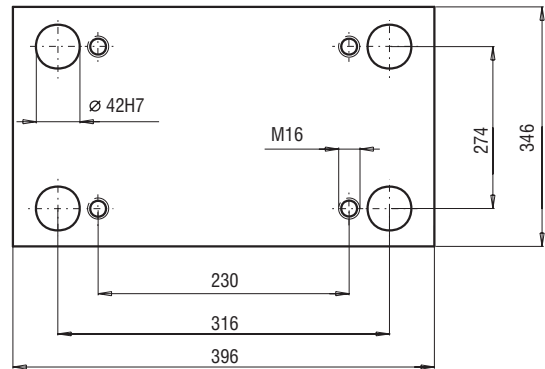

PK 01  
PK 11

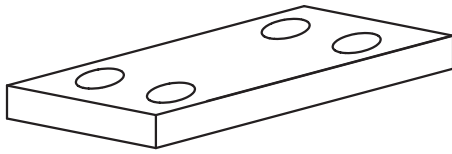
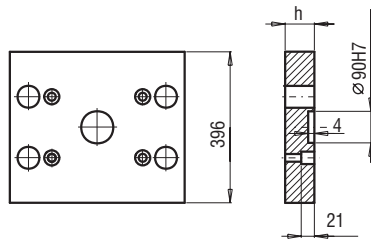
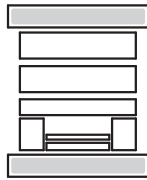

PK 01/396x396x

h	FCPK-1	FCPK-2
27	■	■
36	■	■
46	■	■

PK 11/396x396x

h	FCPK-1	FCPK-2
27	■	■
36	■	■
46	■	■

PK 02  
PK 12

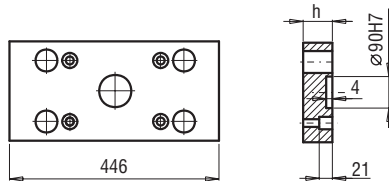
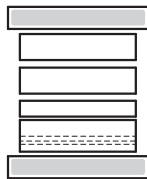

PK 02/346x446x

h	FCPK-1	FCPK-2
27	■	■
36	■	■
46	■	■

PK 12/346x446x

h	FCPK-1	FCPK-2
27	■	■
36	■	■
46	■	■

PK 21  
PK 22

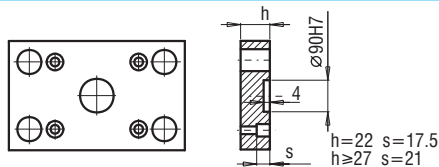
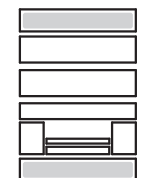

PK 21/346x396x

h	FCPK-1	FCPK-2
22	■	■
27	■	■
36	■	■

PK 22/346x396x

h	FCPK-1	FCPK-2
22	■	■
27	■	■
36	■	■

PK 03  
PK 31

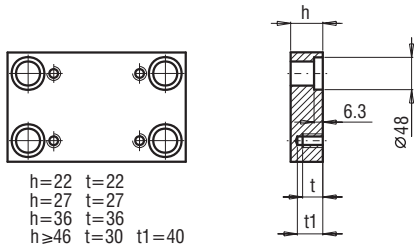

h=22 t=22  
h=27 t=27  
h=36 t=36  
h≥46 t=30 t1=40

PK 03/346x396x  
PK 31/346x396x

h	FCPK-1	FCPK-2	FCPK-3	*	*
22	■	■	■		
27	■	■	■		
36	■	■	■		
46	■	■	■		
56	■	■	■		
66	■	■	■		
76	■	■	■		
86	■	■	■		
96	■	■	■		
116	■	■	■		

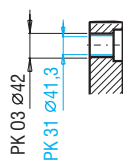

\*Inne gatunki materiałów - patrz str. I.3  
\*For other steel types - see page no I.3

PK 04

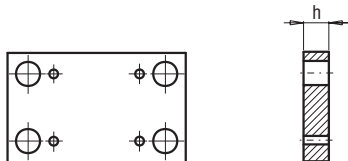

PK 04/346x396x

h	FCPK-1	FCPK-2
27	■	■
36	■	■
46	■	■

PK 05

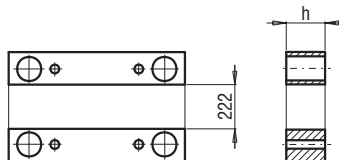

PK 05/62x396x

h	FCPK-1
56	■
66	■
76	■
86	■
96	■
116	■