

Countersunk Headed Punches

GHya d'Y'n'ŭYa 'gfc_ck na

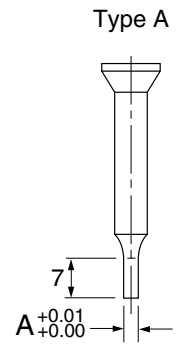

Type B

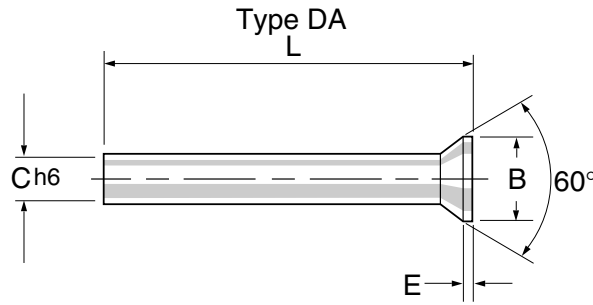
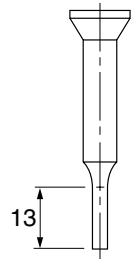

Type C

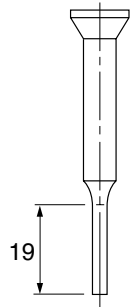

Type D

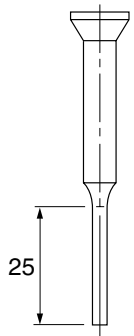

Type AL

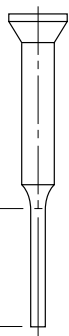

ALTERNATIVE LENGTH SPECIFY
– Inna długość (określić)

Stock length up to 100mm

– Długości do 100mm na magazynie

Intermediate and longer point lengths available

– Pośrednie lub większe długości na życzenie

Any alternative dimensions to the above can be specified

– Inne wymiary na życzenie

Alternative length specify – Inna długość (określić)

C	B	E
1.0–1.1	1.8	0.5
1.15–1.3	2.0	0.5
1.35–1.5	2.2	0.5
1.55–1.7	2.5	0.5
1.75–1.9	2.8	0.5
1.95–2.0	3.0	0.5
2.05–2.2	3.2	0.5
2.25–2.5	3.5	0.5
2.55–2.95	4.0	0.5
3.0–3.4	4.5	0.5
3.5–3.9	5.0	0.5
4.0–4.4	5.5	0.5
4.5–4.9	6.0	0.5
5.0–5.4	6.5	0.5
5.5–5.9	7.0	0.5
6.0–6.4	8.0	0.5
6.5–7.4	9.0	1.0
7.5–8.4	10.0	1.0
8.5–9.4	11.0	1.0
9.5–10.4	12.0	1.0
10.5–11.4	13.0	1.0
11.5–12.4	14.0	1.0
12.5–13.4	15.0	1.0
13.5–14.4	16.0	1.0
14.5–15.4	17.0	1.0

Example order – Przykładowe zamówienie

6 off DAT10C x 5.5 x 70 lg

5 off DAW13A x 10.0 x 4.0 x 7.0 lg

10 off DA6 x 100 lg BLANK

Alternative shapes available, see pages ...

– Inne kształty na życzenie-patrz strony...

Punch Quills (see page ...)

– Oprawki stemplowe (patrz str. ...)

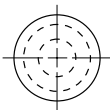

DAT

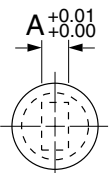

DAR

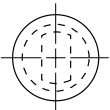

DAF

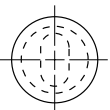

DAW
OVAL

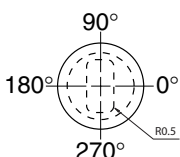

DAL