

Headed/Headless Dies Counter Bore Recess Shaped

Tuleje tnące kształtowe ISO

ISO 8977-1

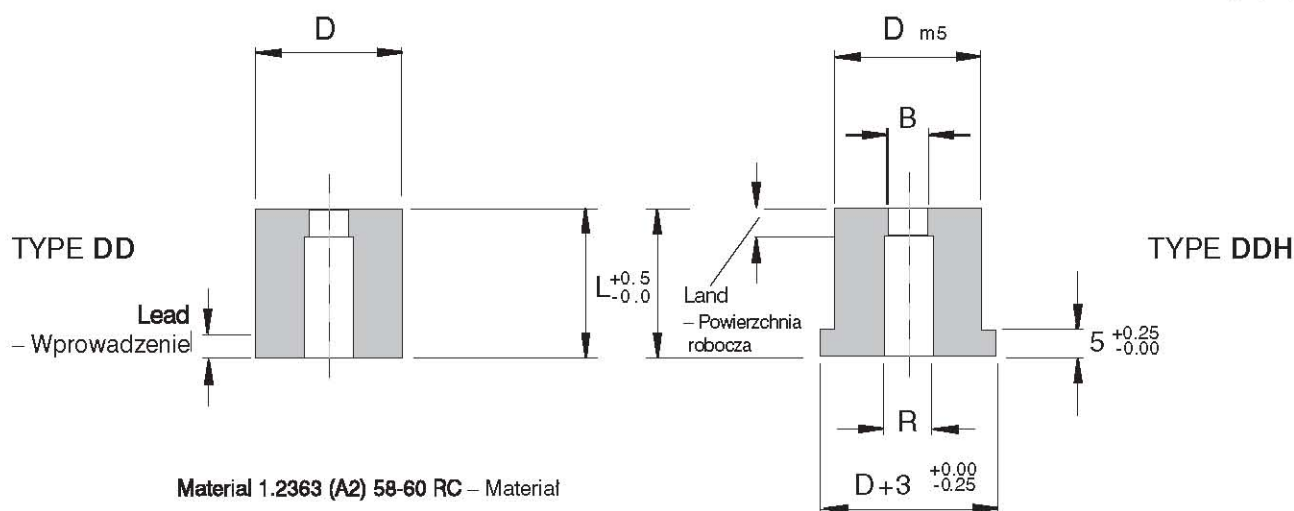

Symbol No's				Headed				D	Land	R Max	L							
											19	20	25	28	30	32	35	40
DDR8	DDF8	DDW8	DDL8	DDHR8	DDHF8	DDHW8	DDHL8	8	3	3.5	*	*	*	*	*	*	*	*
DDR10	DDF10	DDW10	DDL10	DDHR10	DDHF10	DDHW10	DDHL10	10	3	5	*	*	*	*	*	*	*	*
DDR13	DDF13	DDW13	DDL13	DDHR13	DDHF13	DDHW13	DDHL13	13	3	7	*	*	*	*	*	*	*	*
DDR16	DDF16	DDW16	DDL16	DDHR16	DDHF16	DDHW16	DDHL16	16	5	9	*	*	*	*	*	*	*	*
DDR20	DDF20	DDW20	DDL20	DDHR20	DDHF20	DDHW20	DDHL20	20	5	11	*	*	*	*	*	*	*	*
DDR25	DDF25	DDW25	DDL25	DDHR25	DDHF25	DDHW25	DDHL25	25	5	16	*	*	*	*	*	*	*	*
DDR32	DDF32	DDW32	DDL32	DDHR32	DDHF32	DDHW32	DDHL32	32	7	20	*	*	*	*	*	*	*	*
DDR32	DDF32	DDW32	DDL32	DDHR32	DDHF32	DDHW32	DDHL32	32	7	20	*	*	*	*	*	*	*	*
DDR38	DDF38	DDW38	DDL38	DDHR38	DDHF38	DDHW38	DDHL38	38	7	27	*	*	*	*	*	*	*	*
DDR45	DDF45	DDW45	DDL45	DDHR45	DDHF45	DDHW45	DDHL45	45	7	36			*	*	*	*	*	*
DDR50	DDF50	DDW50	DDL50	DDHR50	DDHF50	DDHW50	DDHL50	50	7	41			*	*	*	*	*	*

For dowel & location flats, please specify as shown on pages 57, 58 of main catalogue

– Sposoby zabezpieczenia przed obrotem, patrz strony 57, 58

Alternative shapes available, see pages ... – Inne kształty, patrz strony ...

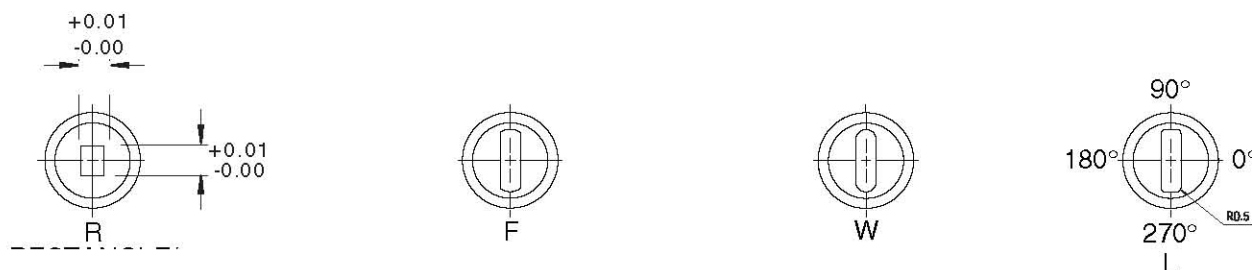

Example Order – Przykładowe zamówienie

1 off DDR10 x 6.1 5.1 x 20

1 off DDHW20 x 9.1 x 5.2 x 32