

15

**Złącze kątowe - 90°
Coupler - angle 90°**



Z zaworem
With valve



Bez zaworu
Without valve

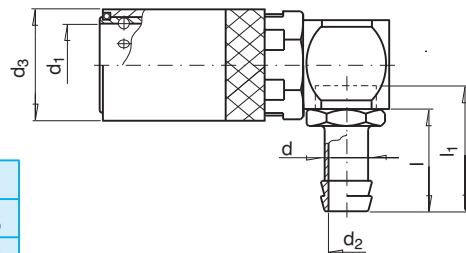
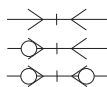

NR KAT.	NR KAT.	NW	d	d ₂	d ₃	d ₁	l	l ₁
HVK 6-06-90°	HK 6-06-90°	6	6	1/4"	4,5	18	9	20
HVK 6-08-90°	HK 6-08-90°		8	5/16"	6	18	9	20
HVK 6-09-90°	HK 6-09-90°		9	5/14"	6	18	9	20
HVK 6-10-90°	HK 6-10-90°		10	3/8"	6	18	9	20
HVK 9-10-90°	HK 9-10-90°	9	10	3/8"	8,5	23	13	27
HVK 9-11-90°	HK 9-11-90°		11	7/16"	9	23	13	27
HVK 9-13-90°	HK 9-13-90°		13	1/2"	10	23	13	27
HVK 16-13-90°	HK 16-13-90°	16	13	1/2"	10	30	20	46
HVK 16-20-90°	HK 16-20-90°		20	3/4"	16	30	20	46

**Złącze proste z gwintem wewnętrznym
Coupler with female thread connection**



Z zaworem
With valve



Bez zaworu
Without valve

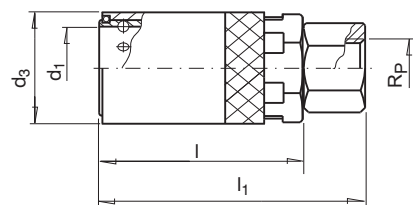
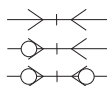

NR KAT.	NR KAT.	NW	R _p	d ₃	d ₁	l	l ₁
HVK 6 DG 10	HK 6 DG 10	6	G 1/8"	17	9	30	39
HVK 6 DG 10M	HK 6 DG 10M		M 10x1	17	9	30	39
HVK 6 DG 13	HK 6 DG 13		G 1/4"	17	9	30	39
HVK 6 DG 14	HK 6 DG 14		M 14x1,5	17	9	30	39
HVK 6 DG 17	HK 6 DG 17		G 3/8"	17	9	30	39
HVK 9 DG 13	HK 9 DG 13	9	G 1/4"	23	13	41	53
HVK 9 DG 17	HK 9 DG 17		G 3/8"	23	13	41	53
HVK 9 DG 21	HK 9 DG 21		G 1/2"	23	13	41	53
HVK 16 DG 21	HK 16 DG 21	16	G 1/2"	30	20	57	76
HVK 16 DG 26	HK 16 DG 26		G 3/4"	30	20	57	76

**Złącze proste z gwintem zewnętrznym
Coupler with male thread connection**



Z zaworem
With valve



Bez zaworu
Without valve

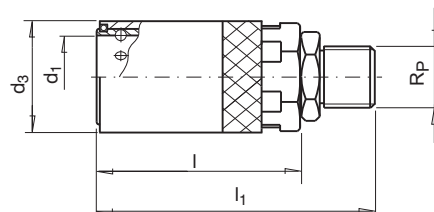
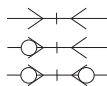

NR KAT.	NR KAT.	NW	R _p	d ₃	d ₁	l	l ₁
HVK 6 EG 10	HK 6 EG 10	6	G 1/8"	17	9	30	43
HVK 6 EG 10M	HK 6 EG 10M		M 10x1	17	9	30	43
HVK 6 EG 13	HK 6 EG 13		G 1/4"	17	9	30	43
HVK 6 EG 14	HK 6 EG 14		M 14x1,5	17	9	30	43
HVK 6 EG 17	HK 6 EG 17		G 3/8"	17	9	30	43
HVK 9 EG 13	HK 9 EG 13	9	G 1/4"	23	13	41	57
HVK 9 EG 16	HK 9 EG 16		M16x1,5	23	13	41	57
HVK 9 EG 17	HK 9 EG 17		G 3/8"	23	13	41	57
HVK 9 EG 18	HK 9 EG 18		M18x1,5	23	13	41	57
HVK 9 EG 21	HK 9 EG 21		G 1/2"	23	13	41	57
HVK 16 EG 21	HK 16 EG 21	16	G 1/2"	30	20	57	76
HVK 16 EG 26	HK 16 EG 26		G 3/4"	30	20	57	76